

KK Exhaust valve

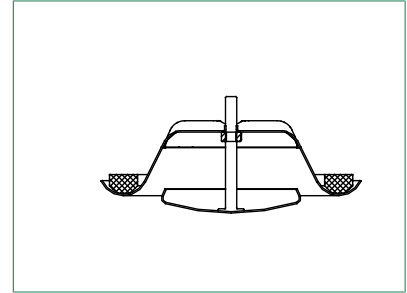

KK exhaust valve is intended for installation in the ceiling or on a wall. The valve is suitable for offices, houses, etc.

Quick Selection

Valve Size	Air flow range l/s at sound level		
	25 dB(A)	30 dB(A)	35 dB(A)
KK-80-C	23	28	34
KK-100-C	30	37	45
KK-125-C	46	57	68
KK-150-C	58	70	81
KK-160-C	64	80	98
KK-200-C	120	140	170

Specifications

- CleanVent coating as standard
- Manufactured from steel sheet.
- Available also in stainless steel.
- Six sizes.

Product code example

Exhaust valve KK-125-C

Air flow, pressure drop, sound level
KK-80-C

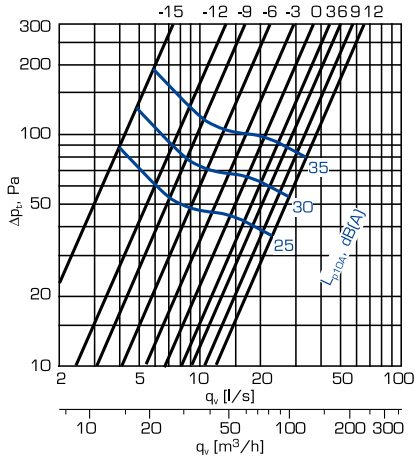

KK-100-C

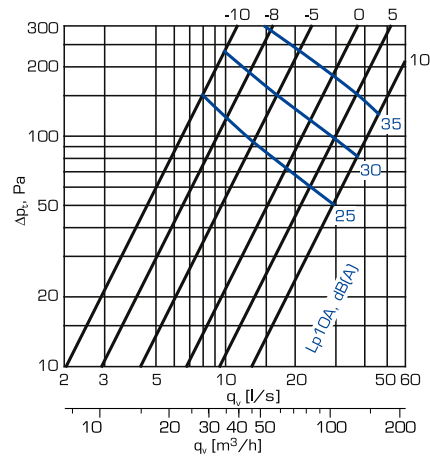

KK-125-C

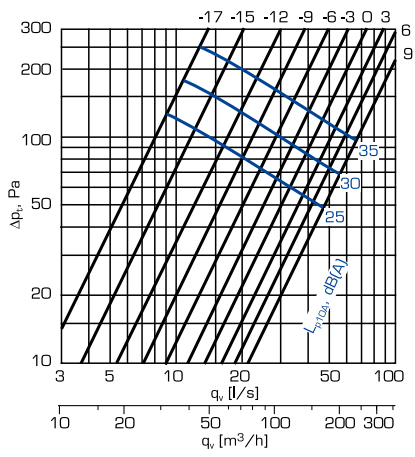

KK-150-C

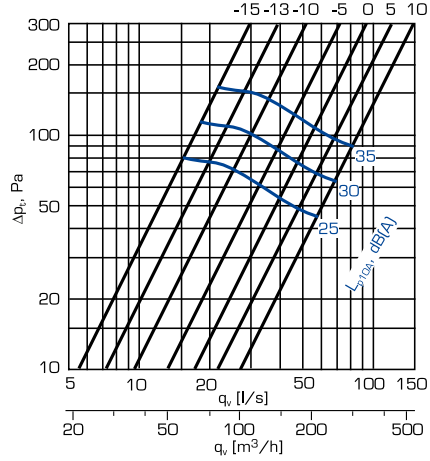

KK-160-C

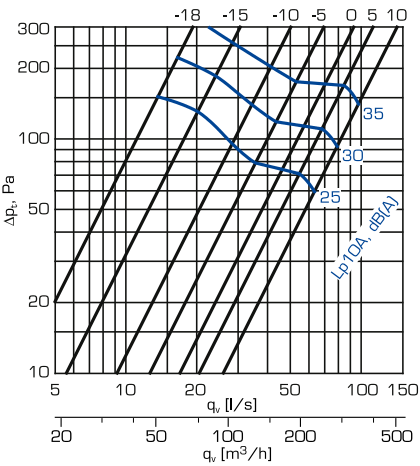

KK-200-C

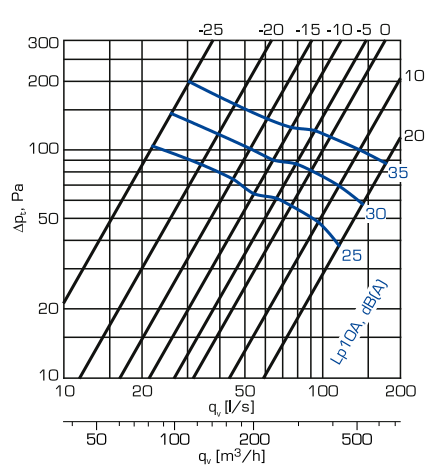

Sound power level L_w

KK	Correction of sound level in dB at octave bands, middle frequency, Hz						
	125	250	500	1000	2000	4000	8000
80	1	-2	1	0	-3	-10	-22
100	5	-2	-3	-3	0	-8	-20
125	-6	0	0	-3	0	-13	-25
150	-6	-5	-4	0	-1	-13	-28
160	1	-1	-3	1	-2	-15	-32
200	3	1	-1	1	-4	-12	-25
Tol. +/-	3	2	2	2	2	2	3

Sound power levels by octave bands are obtained by adding to total sound pressure level L_{p10A} , dB(A) the corrections K_{oct} presented in the table according to the following formula:

$$L_{Woct} = L_{p10A} + K_{oct}$$

Correction K_{oct} is average value in range of use of KK unit.

Sound attenuation ΔL

KK	Slot s (mm)	Sound attenuation in dB at octave bands, middle frequency, Hz							
		63	125	250	500	1000	2000	4000	8000
80	-9	24	20	14	10	8	5	5	6
	0	24	19	13	9	6	3	4	5
	12	24	19	13	9	5	2	3	4
100	-10	23	19	14	12	11	10	13	14
	0	23	16	11	8	7	6	9	8
	10	23	16	11	7	5	4	7	8
125	-17	20	19	13	10	7	7	11	14
	0	18	16	10	6	4	4	5	8
	9	19	16	9	6	3	3	5	7
150	-15	21	14	11	8	6	6	8	8
	0	20	13	9	6	4	4	7	6
	10	16	14	9	4	3	2	7	7
160	-15	18	13	11	7	6	6	8	8
	-10	18	13	10	6	5	5	7	7
	0	17	13	9	5	4	3	6	6
200	-15	17	12	8	7	6	7	8	9
	-5	17	11	7	6	5	6	6	8
	0	17	11	7	5	5	6	6	7
Tol. ±		6	3	2	2	2	2	2	3

The average sound attenuation ΔL from duct to room including the end reflection of the connecting duct in ceiling installation, is obtained in the table above.

Definitions

q_v	air volume	l/s, m ³ /h
Δp_t	total pressure drop	Pa
L_{p10A}	sound pressure level with 4 dB room attenuation (10 m ² sab)	dB(A)
L_{Woct}	sound power level by octave bands	dB
ΔL	sound attenuation	dB
K_{oct}	correction	dB

Dimensions and weight

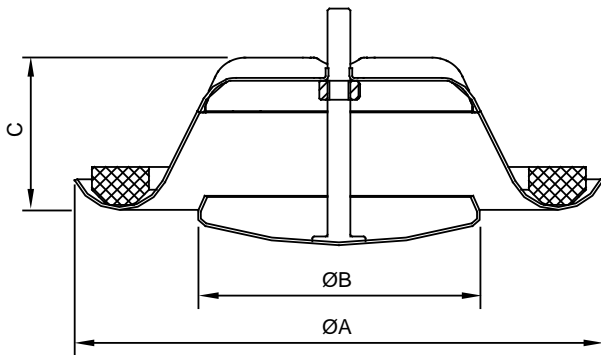

Size	A [mm]	B [mm]	C [mm]	Weight [kg]
80	116	60	40	0.15
100	140	75	40	0.16
125	170	99	46	0.23
150	202	119	54	0.34
160	202	119	54	0.34
200	254	157	64	0.51

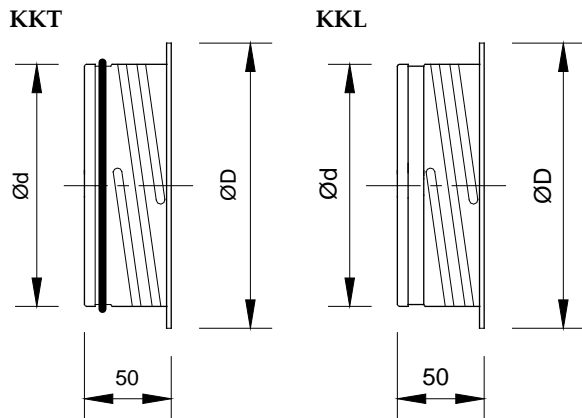

Size	Pack size	Ød [mm]	ØD [mm]	Weight KKT [g]	Weight KKL [g]
80	60	79	101	66	63
100	56	99	122	75	71
125	36	124	148	102	97
150	24	149	175	123	116
160	25	159	184	131	125
200	12	199	225	165	156

General

Construction

The KK is manufactured from steel sheet and painted in white (RAL 9010). Other colours are available to special order. CleanVent coating as standard. Stainless steel version is also available and it is always delivered with a stainless steel version of mounting ring.

Valve body has a gasket made of cellular plastic and the control disc with screw spindle enables easy regulation and positional locking.

Mounting rings KKT and KKL are manufactured from galvanized steel sheet. KKT is equipped with rubber sealing gasket.

Installation

Mounting ring is fitted into the duct with screws or rivets. The valve is fixed by "a screwing action" to locate the valve lugs into indents in the mounting ring. The valve can also be fitted with springs (model KKJ) and the mounting ring is not needed.

Measurement and regulation of air flow

Regulation of air flow is achieved by turning the control disc to change adjustment dimension s (mm).

The measurement of air flow is made by a pressure difference measurement with a separate measuring tube.

Refer to air flow measurement diagrams found in the separate installation and measurement instructions for information.

Descriptive text

Exhaust valve KK, e.g. KK-125-C manufactured by FlaktWoods.

Product code

Exhaust valve
 Exhaust valve with springs

Size (aaa)
 080, 100, 125, 150, 160, 200
 Surface finish (b)
 C = Standard CleanVent coating
 E = Special colour

Exhaust valve, stainless steel
 including mounting ring

Size (aaa)
 100, 125, 160

KK-aaa-b
 KKJ-aaa-b

KK-aaa-R

Accessories and spare parts

Accessories

Mounting ring with rubber gasket KKT-aaa
 Mounting ring without rubber gasket KKL-aaa

Size (aaa)
 080, 100, 125, 150, 160, 200

Spare parts

Seal COGZ-aaa-3

Size (aaa)
 080, 100, 125, 150, 160, 200